

## Connecting Ability Power on a Permobil chair

1. Start by removing the panel on the back of the chair that covers the RNet bus.

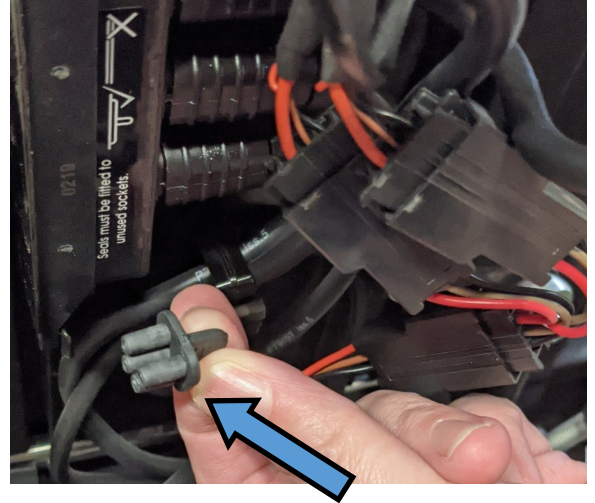

2. Remove the waterproof plug on the RNet bus bar.



3. Plug the RNet cable into the RNet bus on the back of the chair. Note if you are installing an IOM at the same time you will plug in 2 RNet cables that will run parallel.

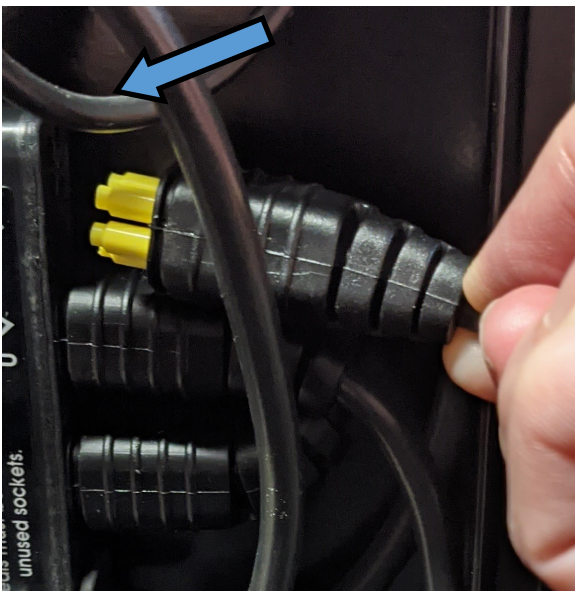

4. Plug the RNet cable into the APR



# Ability Power®

5. Connect the USBC cable, labeled APR Cable Rail to the APR. The APR Rail Cable is male on one end and female on the other end. Note the USB-A port on the APR is for cell phone charging only. DO NOT plug the ADT into the APR.

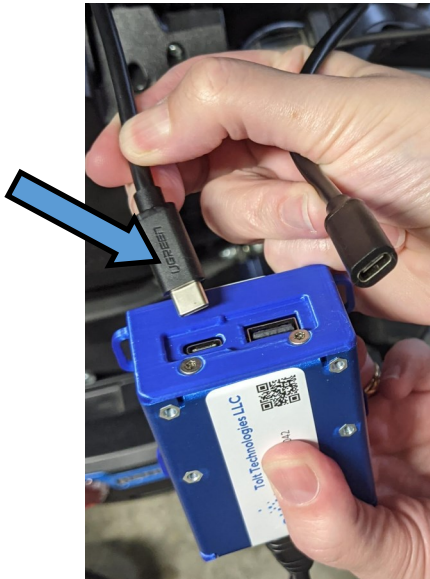

6. Run the USB cable from the APR along the side rail of the chair. Plug the APR Cable Rail and the APR Cable Post together, forming a quick disconnect.

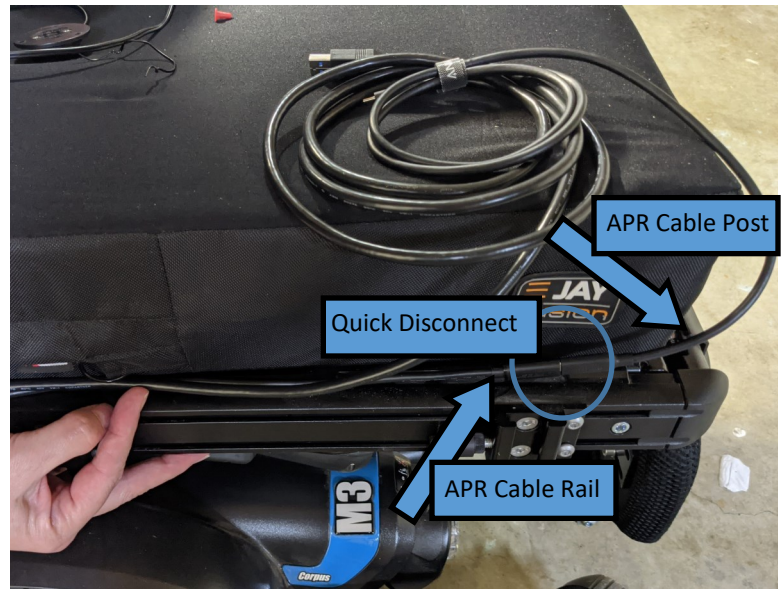

7. Plug the USBC cable from the APR into a USBC power port on a supported device.

See the Tolt Technologies blog for a list of supported devices.

<https://tolttechnologies.com/blog/what-devices-does-ability-drive-work-on/>

